



NEW MANGALORE PORT AUTHORITY

CIVIL ENGINEERING DEPARTMENT

NIT No: CE/SE(C-II) /EST/29/COM/2024.

Date 17 .04.2025

CORRIGENDUM NO- 2

Sub: ALLOTMENT OF LAND ON LONG TERM LEASE ON EASTERN & WESTERN SIDE OF NH-66, FOR COMMERCIAL ACTIVITIES AT NEW MANGALORE PORT THROUGH ETENDER CUM AUCTION PROCESS– Plot Sketch-Extension of bid submission date- Reg

This is in continuation to our Notice Inviting Tender No CE/SE(C-II) /EST/29/ COM /2024 dated 06.03.2025 for subject allotment, uploaded in Central Public Procurement Portal.

The measurements of each individual plot, along with the coordinates of the first plot from both the western and eastern sides of NH-66, are provided in Annexures A and B below.

The Corrigendum No 2 can be downloaded from the NMPA website www.newmangaloreport.gov.in, from the link Tender or E-portal URL:<https://eprocure.gov.in/eprocure/app> and <https://tenders.gov.in>.



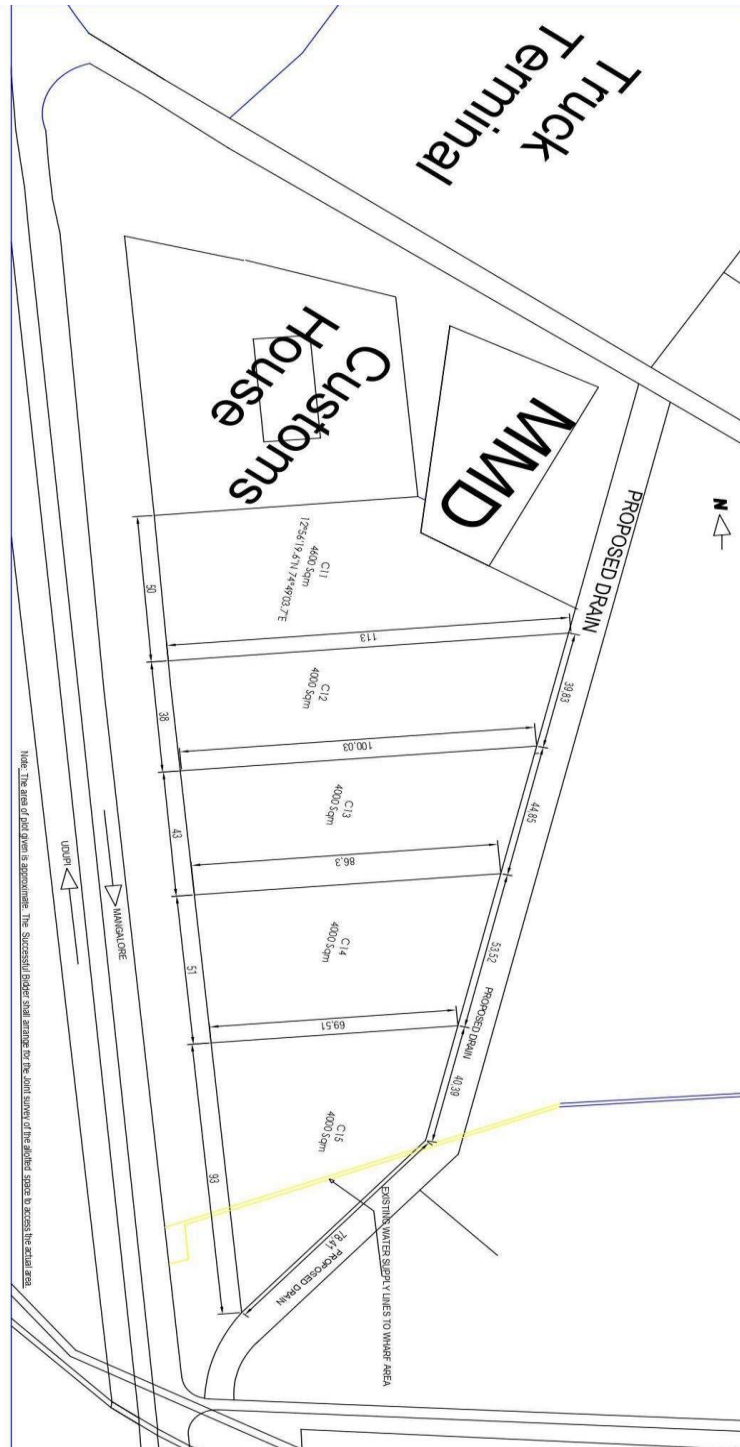

Further, the last date for bid submission has been extended up to **12.05.2025**, and the bid opening is on 13.05.2025 after 15:00 hrs .

-Sd-
CHIEF ENGINEER(CIVIL)