



# NEW MANGALORE PORT AUTHORITY

## Mechanical Engineering Department

Panambur, Mangalore – 575 010.

Phone: 0824- 2887730/701.

No. 20/114/2024-25/EE(M)III-TS(OTM)

Date: 27/02/2025.

To,

The Prospective Bidders,

Sir,

**Sub:** Mech. Div. - "Replacement of Corroded Hand Rails, Vertical poles and Scarping, Cleaning & Painting of Handrails provided in the walkways of Berth No. 11 & 9 with Pump House No.1, 2 & 3" - Budgetary Quotation Requested - Reg.

\*\*\*\*\*

Budgetary Quotations are invited for the work of "Replacement of Corroded Hand Rails, Vertical poles and Scarping, Cleaning & Painting of Handrails provided in the walkways of Berth No. 11 & 9 with Pump House No.1, 2 & 3" as per BOQ and Terms & Conditions detailed below.

Sl. No.	Description of item	Unit	Qty.	Rate in Rs	Amount in Rs.
<b>Berth No.11</b>					
1)	Scraping, cleaning & painting of Vertical Pole 75 x 75 x 8mm thick and 1 mtr. Length with Marine paint with 1) one coat of epoxy primer paint, 2) one coat of epoxy intermediate pain. 3) Two coats of epoxy finish paint of Yellow colour.	Nos.	45		
2)	Scraping, cleaning & painting of Vertical Pole 75 x 75 x 8mm thick and 1.25mtr length with marine paint with 1) one coat of epoxy primer paint. 2) one coat of epoxy intermediate paint. 3) Two coats of epoxy finish paint of Yellow colour.	Nos.	337		
3)	Scraping, cleaning & painting of Vertical Pole 75x75x8mm thick and 1.25mtr. length with base plate of size 150 x 150 x 8 mm thick with marine paint with	Nos.	21		

	<ol style="list-style-type: none"> <li>1) one coat of epoxy primer paint.</li> <li>2) one coat of epoxy intermediate paint.</li> <li>3) Two coats of epoxy finish paint of Yellow colour.</li> </ol>				
4)	<p>Chipping, Scraping, cleaning &amp; Painting of 40 NB dia GI pipe with marine paint with</p> <ol style="list-style-type: none"> <li>1) one coat of epoxy primer paint.</li> <li>2) one coat of epoxy intermediate paint.</li> <li>3) Two coats of epoxy finish paint of Yellow colour.</li> </ol>	Nos.	1133		
5)	<p>Dismantling of existing corroded Handrail unit which includes vertical pole with Hand Rail Pipes, laid along the service Platform of Berth No.11 and Mooring Dolphin walkway No.2-3, 3-4, and 7-8 by Gas cutting/angle cutter.</p> <p>Shifting &amp; stacking of dismantled items in the open area between Tower Monitor at Berth No. 11.</p>	Lump sum	Lump sum		
6)	<p>Fabrication, Supply &amp; Fixing of New Vertical Pole. from ISA <b>75 x 75 x 8 mm thickness</b> of length <b>1mtr</b> welded with bottom plate of 150 mm x 150 mm x <b>16 mm thick</b>.</p> <ol style="list-style-type: none"> <li>a) 4 Nos. of holes to be drilled on bottom plate for fixing of M12x100 mm GI wedge anchor bolts (Including supply of GI wedge anchor bolts)</li> <li>b) 4 Nos. 10 mm dia holes to be drilled on Vertical Pole for fixing of horizontal hand rail pipe using M8 size GI U bolts. (Including supply of M8 size GI U bolts)</li> </ol> <p>Before fixing of <b>Vertical Pole unit</b>, the same to be painted with marine paint with</p> <ol style="list-style-type: none"> <li>1) one coat of epoxy primer paint.</li> <li>2) one coat of epoxy intermediate paint.</li> <li>3) one coat of epoxy yellow color finish paint.</li> <li>4) One more coat of epoxy yellow color finish paint to be applied after fixing the same in site.</li> </ol>	Nos.	102		
7)	<p>Fabrication, Supply and fixing of New Vertical Pole from ISA <b>75 x 75 x 8 mm thickness</b> of length <b>200mm</b> welded with bottom plate of 150 mm x 150 mm x <b>10 mm thick</b>. 4 Nos. of holes to be drilled on bottom plate for fixing of M12x100 mm GI wedge anchor bolts fastener including supply of GI anchor bolts, nuts &amp; washers.</p>	Nos.	7		

	<p>Before fixing of <b>Vertical Pole unit</b>, the same to be painted with marine paint with</p> <ol style="list-style-type: none"> <li>1) one coat of epoxy primer paint.</li> <li>2) one coat of epoxy intermediate paint.</li> <li>3) one coat of epoxy yellow color finish paint.</li> <li>4) One more coat of epoxy yellow color finish paint to be applied after fixing the same in site.</li> </ol>				
8)	<p>Fabrication, Supply and Fixing of New Vertical Pole from ISA <b>75 x 75 x 8 mm thickness</b> of length <b>1.25 mtrs.</b> and 2 Nos. of holes to be drilled on top the Vertical Pole for fixing of 40 NB GI Pipe and 2 Nos. holes to be drilled on bottom for fixing of Vertical Pole using M16 X 100 mm GI wedge anchor bolts.</p> <p>Before fixing of <b>Vertical Pole unit</b>, the same to be painted with marine paint with</p> <ol style="list-style-type: none"> <li>1) one coat of epoxy primer paint.</li> <li>2) one coat of epoxy intermediate paint.</li> <li>3) one coat of epoxy yellow color finish paint.</li> <li>4) One more coat of epoxy yellow color finish paint to be applied after fixing the same in site.</li> </ol>	Nos.	25		
09)	<p>Supply of New 32 mm NB GI Pipe (B class) conforming to IS 1239(Part 1) 2004 and laying of the same to Vertical Pole horizontally in two rows by M8 size GI U Bolt fasteners including supply of GI U bolts, nuts &amp; washers. The hand rail pipes to be joined using GI coupling &amp; the end points of the GI pipe railing to be provided with bend and should be closed to avoid internal corrosion including supply of coupling, bend etc complete required for jointing of pipes and end protrude. Before fixing of <b>Hand Rails Pipes,,</b> the same to be painted with marine paint with</p> <ol style="list-style-type: none"> <li>1) one coat of epoxy primer paint.</li> <li>2) one coat of epoxy intermediate paint.</li> <li>3) one coat of epoxy yellow color finish paint.</li> <li>4) One more coat of epoxy yellow color finish paint to be applied after fixing the same in site.</li> </ol>	Mtrs	196		
10)	<p>Supply of New 40 mm NB GI Pipe (B class) conforming to IS 1239(Part 1) 2004 and laying of the same to the existing Vertical Pole</p>	Mtrs	200		

	<p>horizontally in two rows. The hand rail / pipes to be joined using GI coupling &amp; the end points of the GI pipe railing to be provided with bend and should be closed to avoid internal corrosion including supply of coupling, bend etc, complete required for jointing of pipes and end protrude. Before fixing of <b>Hand Rails Pipes,,</b> the same to be painted with marine paint with</p> <ol style="list-style-type: none"> <li>1) one coat of epoxy primer paint.</li> <li>2) one coat of epoxy intermediate paint.</li> <li>3) one coat of epoxy yellow color finish paint.</li> <li>4) One more coat of epoxy yellow color finish paint to be applied after fixing the same in site.</li> </ol>				
<b>Berth No.9</b>					
11)	<p>Dismantling of existing handrails, which includes hand rail pipes, Vertical Pole with bottom plate complete, laid along the approach to service platform of Berth No. 9, by gas cutting/angle cutter.</p> <p>Shifting and stacking of dismantled items near Berth No. 9 Tower.</p>	Lumsum	-		
12)	<p>Fabrication , Supply and fixing of New Vertical Pole from ISA 75 x 75 x 8 mm thickness of length 1.2mtr welded with bottom plate of 150 x 150 x 12 mm thick.</p> <ol style="list-style-type: none"> <li>a) 4 Nos. of holes to be drilled on bottom plate for fixing of M12x100 mm GI wedge anchor bolts.</li> <li>4 Nos. 10 mm dia holes to be drilled on Vertical Pole for fixing of horizontal hand rail pipe using M8 size GI U bolt.</li> </ol> <p>Before fixing of <b>Vertical Pole unit,</b> the same to be painted with marine paint with</p> <ol style="list-style-type: none"> <li>1) one coat of epoxy primer paint.</li> <li>2) one coat of epoxy intermediate paint.</li> <li>3) One coat of epoxy yellow color finish paint.</li> <li>b) One more coat of epoxy yellow color finish paint to be applied after fixing the same in site.</li> </ol>	Nos.	111		
13)	<p>Supply of 32 mm NB New GI Pipe (B class) conforming to IS 1239(Part 1) 2004 and laying of the same to Vertical Pole horizontally in two rows by M8 size GI U Bolt fasteners including</p>	Mtrs.	400		

	<p>supply of GI U bolts, nuts &amp; washers. The hand rail pipes to be joined using GI coupling &amp; the end points of the GI pipe railing to be provided with bend and should be closed to avoid internal corrosion including supply of coupling, bend etc complete required for jointing of pipes and end protrude.</p> <p>Before fixing of <b>Hand Rails Pipes,,</b> the same to be painted with marine paint with</p> <ol style="list-style-type: none"> <li>1) one coat of epoxy primer paint.</li> <li>2) one coat of epoxy intermediate paint.</li> <li>3) one coat of epoxy yellow color finish paint.</li> <li>4) One more coat of epoxy yellow color finish paint to be applied after fixing the same in site.</li> </ol>				
<b>Pump House No. 1</b>					
14)	<p><u>Approach line to Pump House</u> Scraping, cleaning &amp; painting of 75 x 75 x 6mm thick 1.1mtr. length with marine paint with</p> <ol style="list-style-type: none"> <li>1) one coat of epoxy primer paint.</li> <li>2) one coat of epoxy intermediate paint.</li> <li>3) Two coats of epoxy finish paint of Yellow colour.</li> </ol>	Nos.	30		
15)	<p>Scraping, cleaning &amp; Painting of 40 NB dia GI pipe with marine paint with</p> <ol style="list-style-type: none"> <li>1) one coat of epoxy primer paint.</li> <li>2) one coat of epoxy intermediate paint.</li> <li>3) Two coats of epoxy finish paint of Yellow colour.</li> </ol>	Mtrs.	120		
16)	<p><u>Surrounding Pump House</u> Scraping, cleaning &amp; painting of 75 x 75 x 6mm thick 1mtr. length with base plate of size 150 x 150 x 8 mm thick with marine paint with</p> <ol style="list-style-type: none"> <li>1) one coat of epoxy primer paint.</li> <li>2) one coat of epoxy intermediate paint.</li> <li>3) two coats of epoxy finish paint of Yellow colour.</li> </ol>	Nos.	54		
17)	<p>Scraping, cleaning &amp; Painting of 40 NB dia GI pipe with marine paint with</p> <ol style="list-style-type: none"> <li>1) one coat of epoxy primer paint.</li> <li>2) one coat of epoxy intermediate paint.</li> <li>3) Two coats of epoxy finish paint of Yellow colour.</li> </ol>	Mtrs.	150		
18)	<p><u>Walkway of Pump House</u> Scraping, cleaning &amp; Painting of 175 x 80 x 6mm 'C' Channel with marine paint with</p> <ol style="list-style-type: none"> <li>1) one coat of epoxy primer paint.</li> <li>2) one coat of epoxy intermediate paint.</li> </ol>	Mtrs.	15		

	3) Two coats of epoxy finish paint of Yellow colour.				
19)	Scraping, cleaning & Painting of 110 x 50 x 6mm 'C' Channel with marine paint with 1) one coat of epoxy primer paint. 2) one coat of epoxy intermediate paint. 3) Two coats of epoxy finish paint of Yellow colour.	Mtrs.	18		
20)	Scraping, cleaning & painting of 75 x 7 x 6mm thick 600mm mtr. Length with marine paint with  1) one coat of epoxy primer paint. 2) one coat of epoxy intermediate paint. 3) Two coats of epoxy finish paint of Yellow colour.	Nos.	20		
21)	Scraping, cleaning & painting of 80 x 45 x 4mm thick 600mm mtr. Length with marine paint with 1) one coat of epoxy primer paint. 2) one coat of epoxy intermediate paint. 3) two coats of epoxy finish paint of Yellow colour.	Mtrs.	11		
22)	Scraping, cleaning & painting of 40 NB dia GI pipe with marine paint with 1) one coat of epoxy primer paint. 2) one coat of epoxy intermediate paint. 3) Two coats of epoxy finish paint of Yellow colour.	Mtrs.	26		
23)	Supply of 32 mm NB New GI Pipe (B class) conforming to IS 1239(Part 1) 2004 and laying of the same to Vertical Pole horizontally in two rows by M8 size GI U Bolt fasteners including supply of GI U bolts, nuts & washers. The hand rail pipes to be joined using GI coupling & the end points of the GI pipe railing to be provided with bend and should be closed to avoid internal corrosion including supply of coupling, bend etc complete required for jointing of pipes and end protrude. Before fixing of <b>Hand Rails Pipes</b> , the same to be painted with marine paint with 1) one coat of epoxy primer paint. 2) one coat of epoxy intermediate paint. 3) one coat of epoxy yellow color finish paint. 4) One more coat of epoxy yellow color finish paint to be applied after fixing the	Mtrs.	64		

	same in site.				
24)	<p>Fabrication, Supply and Fixing of New Vertical Pole from ISA 75 x 75 x 8 mm thickness of length 1.2mtr welded with bottom plate of 150 x 150 x 12 mm thick. 4 Nos. of holes to be drilled on bottom plate for fixing of M12x100 mm GI wedge anchor bolts.</p> <p>a) 4 Nos. 10 mm dia holes to be drilled on Vertical Pole for fixing of horizontal hand rail pipe using M8 size GI U bolt. Before fixing of <b>Hand Rails Pipes,,</b> the same to be painted with marine paint with</p> <ol style="list-style-type: none"> <li>1) one coat of epoxy primer paint.</li> <li>2) one coat of epoxy intermediate paint.</li> <li>3) one coat of epoxy yellow color finish paint.</li> <li>4) One more coat of epoxy yellow color finish paint to be applied after fixing the same in site.</li> </ol>	Nos.	32		

### Pump House No. 2

25)	<p>Scraping, cleaning &amp; painting of 50 x50 x5mm thick 1.1mtr. length with base plate of size 150 x 150 x 10 mm thick with marine paint with</p> <ol style="list-style-type: none"> <li>1) one coat of epoxy primer paint,</li> <li>2) one coat of epoxy intermediate paint.</li> <li>3) Two coats of epoxy finish paint of Yellow colour</li> </ol>	Nos.	19		
26)	<p>Scraping, cleaning &amp; Painting of 40 NB dia GI hand rail pipe with marine paint with</p> <ol style="list-style-type: none"> <li>1) one coat of epoxy primer paint.</li> <li>2) one coat of epoxy intermediate paint.</li> <li>3) Two coats of epoxy finish paint of Yellow colour, including supply of paint &amp; thinner.</li> </ol>	Mtrs	66		

### Pump House No. 3

27)	<p>Scraping, cleaning &amp; painting of 75 x 40x4mm 920mtr. length with base plate of size 150 x 150 x 10 mm thick with marine paint with</p> <ol style="list-style-type: none"> <li>1) one coat of epoxy primer paint.</li> <li>2) one coat of epoxy intermediate paint.</li> </ol>	Nos.	42		
-----	--	------	----	--	--

	3) Two coats of epoxy finish paint of Yellow colour.				
28)	<p>Fabrication, Supply and Fixing of New Vertical Pole from ISA <b>75 x 40 x 4 mm thickness</b> of length <b>920 mtrs.</b> with base plate of size 150 x 150 x 10 mm thick 4 Nos. of holes to be drilled on bottom plate for fixing of M12x100 mm GI wedge anchor bolts 2 Nos. of holes to be drilled on top the Vertical Pole for fixing of 40 NB GI Pipe.</p> <p>Before fixing of <b>Vertical Pole unit</b>, the same to be painted with marine paint with</p> <ol style="list-style-type: none"> <li>1) One coat of epoxy primer paint.</li> <li>2) one coat of epoxy intermediate paint.</li> <li>3) one coat of epoxy yellow color finish paint.</li> <li>4) One more coat of epoxy yellow color finish paint to be applied after fixing the same in site.</li> </ol>	Nos.	20		
<b>Sub Total (Sl.No.1 to Sl.No.28)</b>					
<b>GST @.....%</b>					
<b>Grand Total</b>					

**Enclosed:**

- a) The schematic sketch of the Vertical Pole with base plate is attached as **ANNEXURE – A**
- b) The schematic sketch of the Vertical Pole is attached as **ANNEXURE – B**
- c) The Sketch of M8 size GI U bolt with specification is attached as **ANNEXURE-C**

**Terms & Conditions:**

- 1) The rates quoted by the Tenderer shall be inclusive of cost of labour charges, transportation charges, tools & tackles, wire brush, scrappers, cotton waste, painting brush/roller, paint & thinner etc. complete required for carrying out the painting work.
- 2) The rate quoted shall be firm and final and inclusive of all taxes & duties excluding GST. GST as applicable shall be paid extra. GST shall be quoted separately.
- 3) Income Tax at the applicable rates will be recovered from the gross amount of the firm's bill as per the relevant provisions of the Acts.
- 4) The quotation shall be valid for a period of 60 days from the date of opening of the quotation.
- 5) The Tenderers may visit the work site (Oil Jetty Area), NMPA and access the details of work to be carried out and get acquainted with the work involved before submitting the quotations by contacting the AEE(M), OTM Sub Division or the undersigned. Any assistance in this regard will be provided by the Department.



- 6) The contractor shall be responsible for taking precautionary measures for the safety of the work men working under him and the responsibility arising due to any mishap during the execution of work, the payment of any compensation, if any, etc. lies entirely on the part of the contractor. The contractor has to employ skilled and competent workers for carrying out the work.
- 7) (i) The time allowed for mobilization of materials, fabrication and delivery of components to NMPA site is 45 days from the date of issue of work order.  
(ii) Erection work at site shall be commenced within 45 days from the date of issue of work order. The time allowed for completion of erection work at site is 30 working days, after mobilization period of 45 days for procurement of materials, pre fabrication and delivery at NMPA site.  
(ii) During Berthing of Oil Tankers at Oil Jetty, the permission for carrying out the Chipping/Hot Work will not be allowed. Number of days for the completion of the work will be counted the days of non-occupancy of tankers in the respective Berths.
- 8) The contractor is required to be equipped with manpower and materials, equipment, tools & tackles, consumables etc. required for carrying out the work at all time and commence the work within 24 Hrs. after the information is passed on to him regarding the free availability of Jetty.
- 9) The contractor shall obtain hot work permission from the competent authority of NMPA for carrying out the hot works. The copy of the same shall be given to AEE(M), OTM Sub Div. before commencing the works.
- 10) Free electricity and water supply will be given for the said works.
- 11) Power supply shall be given to the Contractor on free of cost. Tapping of power from the source point of NMPT to the required location will have to be arranged by the Contractor at his cost conforming to IE Rules / Standard.
- 12) During fixing of vertical pole, if the existing cable tray fallen the cable tray clamping bolts may be loosed and retightened after fixing of the vertical pole.
- 13) Manufacturers' certificate for ISA & Plate shall be submitted along with the supply.
- 14) The supplied GI pipes & fittings should confirm to the IS standards and necessary manufacturers certificate shall be submitted along with the supply.
- 15) The paint coats shall be smooth and even and shall not show any trace of marks.
- 16) Any damages to the departmental properties during the execution of works will be on contractors account.
- 17) No tools, plant, labour, equipment, consumable, transport etc. required for the work will be supplied by the Department and the Contractor has to make his own arrangements.
- 18) The work will be carried out to the entire satisfaction of Engineer in charge of the Department.
- 19) The free wharf entry passes to the personnel and their vehicle (Red Pass) shall be provided by the Department as per the Rules. The request letter along with required documents for the same shall be provided by the Contractor well in advance indicating the details of vehicle and driver.
- 20) The work carried out shall be guaranteed for a period of 6 months from the date of completion of work.
- 21) Liquidated Damages for delay in completion:  
In the event of failure by the contractor to complete the works within stipulated time or on the expiry of any period of extension granted by the Port, the liquidated damages @ 0.5% per week subject to a maximum of 10% of contract value will be levied.
- 21) No advance payment will be made. But, 90% payment will be made through E-payment after satisfactory completion of work to the entire satisfaction of the Engineer-in-Charge

and within 15 days from the date of submission of bills. The balance 10% payment will be withheld towards the security deposit. The security deposit will be released without interest after completion of six month guarantee period reckoning from the date of overall completion of the work.

- 22) The contractor shall submit the bill to the Executive Engineer (M)III after completion of work.
- 23) The competent authority of NMPA reserves the right to reject any or all the quotations without assigning any reasons.
- 24) The Budgetary offer enclosed in a sealed cover super scribed as "Replacement of Corroded Hand Rails, Vertical poles and Scarping, Cleaning & Painting of Handrails provided in the walkways of Berth No. 11 & 9 with Pump House No.1, 2 & 3" should reach to the under signed on or before 10/03/2025 at 15:00 Hrs. to the below mentioned address. Quotation will be opened on the same day at 16.00 Hrs. in the presence of the bidders who wish to be present.



27/2/25

(Chandrashekar)

कार्यपालक अभियंता, (एम) III  
Executive Engineer, (M) III  
नव मंगलूर पोर्ट प्राधिकरण  
New Mangalore Port Authority  
पणंबूर, मंगलूर - 575010  
Panambur, Mangalore - 575 010

**Address for Communication:**

Executive Engineer (M)I,  
Administrative Building, 2<sup>nd</sup> Floor,  
Room No.234,  
New Mangalore Port Authority,  
Panambur, Mangalore – 575010.  
Mob: 9448910767, Ph: 0824-2887710  
Email: [chandrashekar.vn@nmpt.gov.in](mailto:chandrashekar.vn@nmpt.gov.in)

27/2/25

# SPECIFICATION OF VERTICAL POLE WITH BASE PLATE

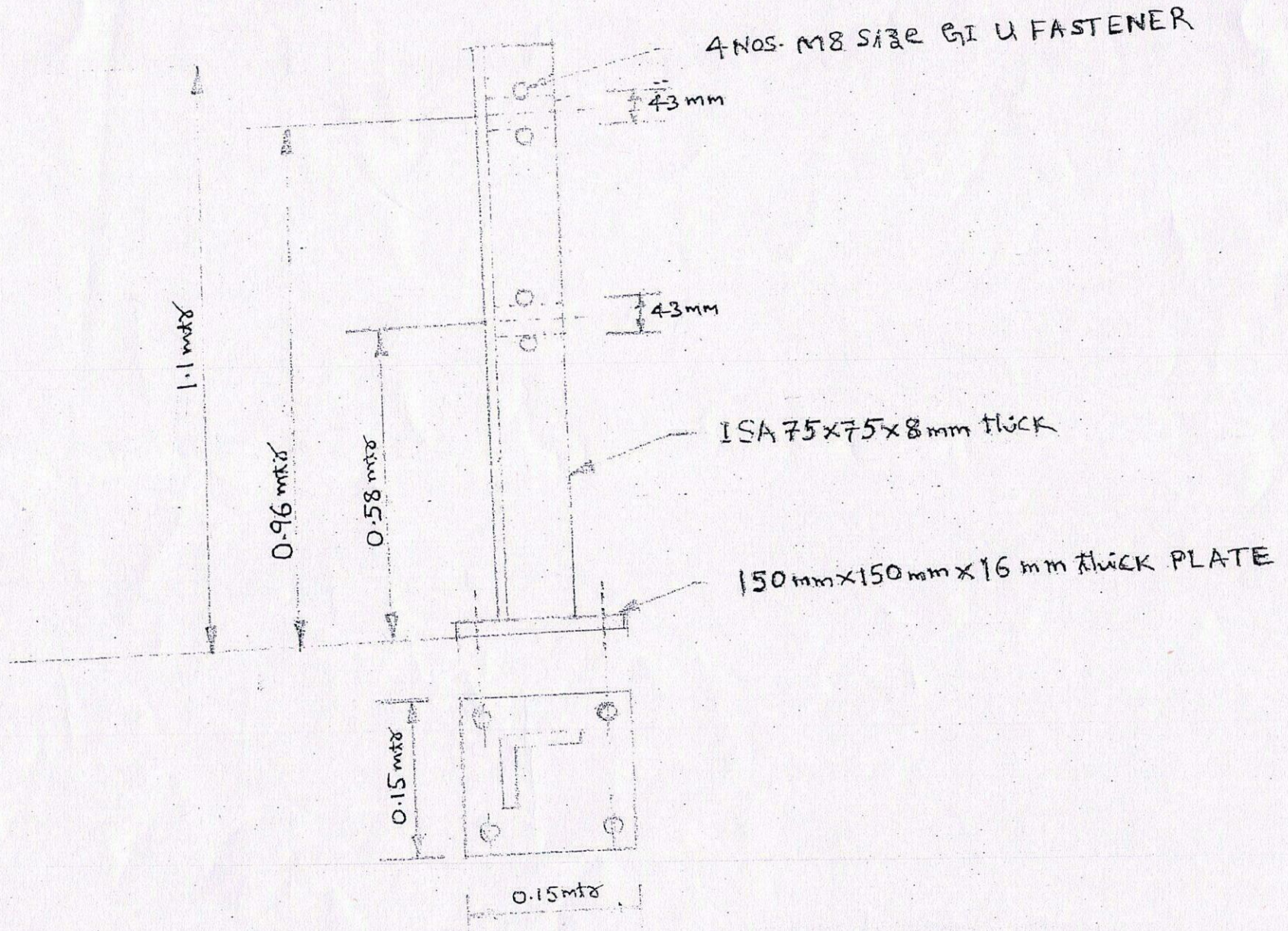

ANNEXURE-B  
SPECIFICATION OF VERTICAL POLE

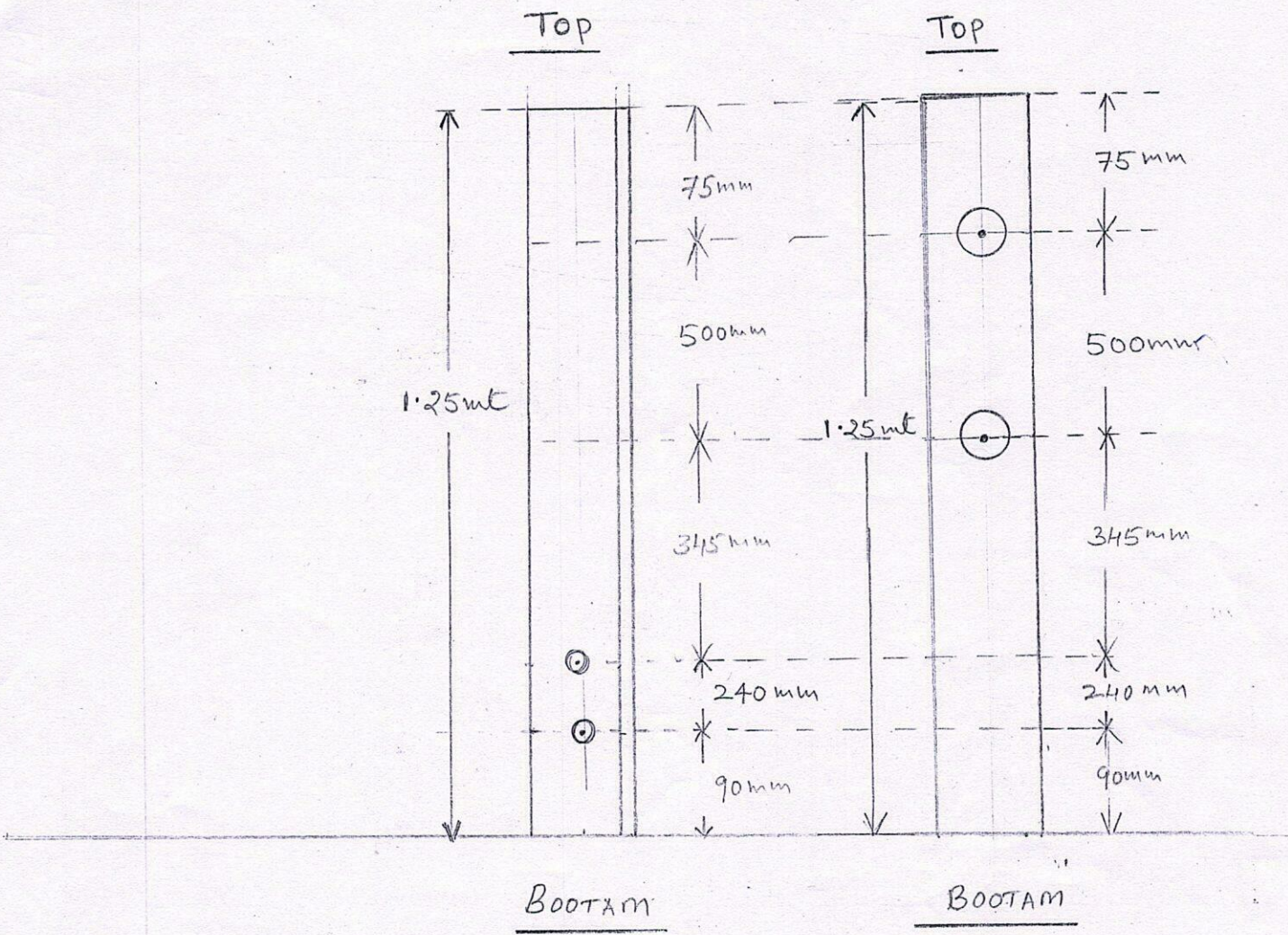

# ANNEXURE - C

## SPECIFICATION OF M8 size GI U BOLT

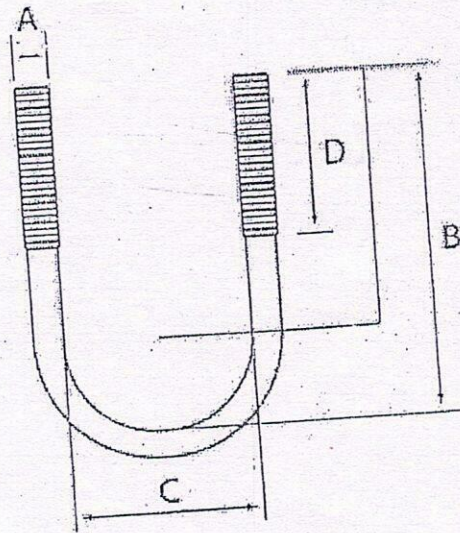

Technical Data			
Thread Diameter	B(mm)	C(mm)	D(mm)
M8	68	43	25