

BATHYMETRY CHART

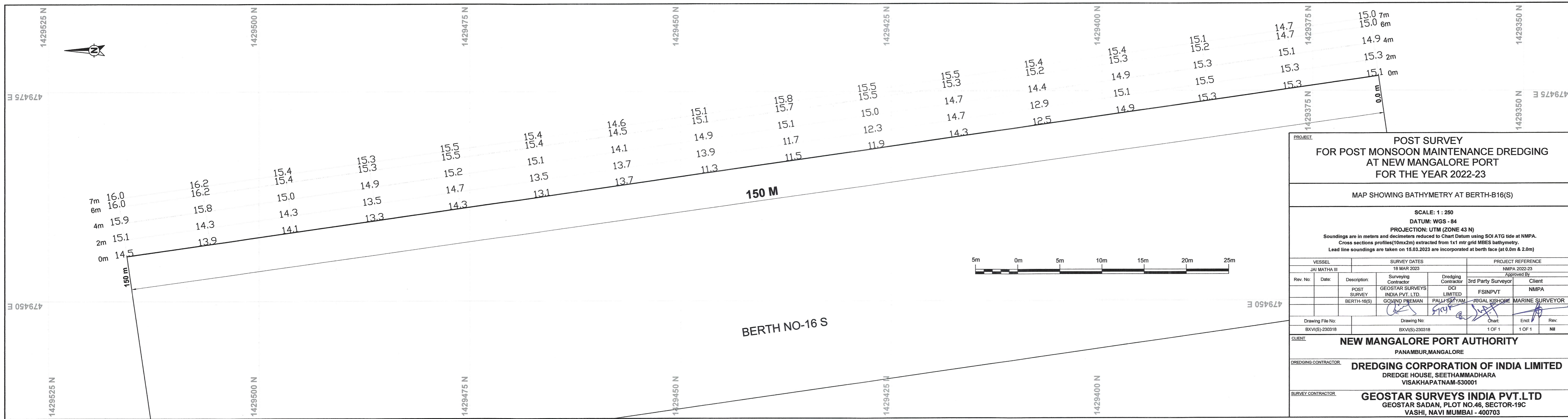

**POST SURVEY  
FOR POST MONSOON MAINTENANCE DREDGING  
AT NEW MANGALORE PORT  
FOR THE YEAR 2022-23**

MAP SHOWING BATHYMETRY AT BERTH-B16(S)

SCALE: 1 : 250  
DATUM: WGS - 84  
PROJECTION: UTM (ZONE 43 N)  
Soundings are in meters and decimeters reduced to Chart Datum using SOI ATG tide at NMPA.  
Cross sections profiles(10mx2m) extracted from 1x1 mtr grid MBES bathymetry.  
Lead line soundings are taken on 15.03.2023 are incorporated at berth face (at 0.0m & 2.0m)

VESSEL		SURVEY DATES		PROJECT REFERENCE		
JAI MATHA III		18 MAR 2023		NMPA 2022-23		
Rev. No.	Date:	Description:	Surveying Contractor	Dredging Contractor	3rd Party Surveyor	Client
		POST SURVEY BERTH-16(S)	GEOSTAR SURVEYS INDIA PVT. LTD.	DCI LIMITED	FSINPVT	NMPA
			GOWIND PREMAN	PALLI SATYAM	JOGAL KISHORE	MARINE SURVEYOR
Drawing File No:		Drawing No:		Chart:		Rev:
BXVI(S)-230318		BXVI(S)-230318		1 OF 1		1 OF 1 Nil
<b>CLIENT:</b>						
<b>NEW MANGALORE PORT AUTHORITY</b>						
PANAMBUR, MANGALORE						
<b>DREDGING CONTRACTOR:</b>						
<b>DREDGING CORPORATION OF INDIA LIMITED</b>						
DREDGE HOUSE, SEETHAMMADHARA VISAKHAPATNAM-530001						
<b>SURVEY CONTRACTOR:</b>						
<b>GEOSTAR SURVEYS INDIA PVT.LTD</b>						
GEOSTAR SADAN, PLOT NO.46, SECTOR-19C VASHI, NAVI MUMBAI - 400703						