



# NEW MANGALORE PORT AUTHORITY

## Mechanical Engineering Department

Panambur, Mangalore - 575 010

Phone: 0824 - 2887730 / 701

**No. 20/114/2023-24/EE(M)III-TS(OTM)**

**Date: 13/04/2023**

To,  
The Prospective Bidders,

Sir,

**Sub :** NMPA- Mech. Div. - Supply of SS 316 Jumbo Water Curtain Nozzles with Coupling (Adapter) - Quotations - Requested - Reg.

\*\*\*\*\*

Quotations are invited for "Supply of SS 316 Jumbo Water Curtain Nozzles with Coupling (Adapter)" as per BOQ and Terms & Conditions detailed below.

Sl. No.	Description of item	Qty.	Unit	Rate in Rs.	Amount in Rs.
1	Supply of SS316 Coupling (Adapter) for Jumbo Water Curtain Nozzles as per <b>Annexure -1.</b>	28	No.		
2	Supply of SS316 Jumbo Water Curtain Nozzles of 362 LPM (Liters per minute) discharge @7 Kg/cm <sup>2</sup> pressure as per <b>Annexure -1.</b> <b>Note:</b> The Projectile Curve of Jumbo Water Curtain Nozzles is enclosed as <b>Annexure -2.</b>	28	No.		
Sub Total					
GST @.....%					
<b>Grand Total</b>					

**Terms and conditions:**

1. The rate quoted shall be firm and final and inclusive of all taxes & duties excluding GST. GST as applicable shall be paid extra. GST shall be quoted separately.
2. The rate quoted should be valid for at least 45 days from the due date of submission of offer.
3. The successful bidder shall supply twenty eight (28) numbers of Jumbo Water Curtain Nozzles with Coupling (Adapter) which shall be able to produce dense water curtain of 20 meters radius through 15° angle in vertical plane with width of spray 5 mtrs. at discharge rate of 362 LPM of sea water at inlet pressure of 7 kg/cm<sup>2</sup> (max). The Nozzles & Coupling (Adapter) shall be of SS 316 materials and of 1"BSPT thread (M & F) size as per the Technical Data Sheet & Drawing (**Annexure .1**). The Projectile Curve of Jumbo Water Curtain Nozzles is enclosed as **Annexure .2**.
4. The time allowed for supply of SS 316 Jumbo Water Curtain Nozzles with Coupling (Adapter) is 45 days from the date of issue of work order. The supplied items shall be inspected in the works of manufacturer by any one of the following Third Party Inspection (TPI) Agency viz. IR Class System and Solutions Pvt. Ltd., ABS Industrial Verification (Pvt.) Ltd., DNV, Bureau Veritas (I) Pvt. Ltd. and Lloyds Inspection Agency Pvt. Ltd., before dispatch. The TPI Agency shall inspect the manufacturer's certificate of supply items, visual inspection of supply items and witnessing the flow rate of 362 LPM (Liters per minute) and Vertical throw & width of spray at discharge pressure of 7 Kg/cm<sup>2</sup> at works of the manufacturer as per the Technical Data Sheet & Drawing (**Annexure .1**). The items shall be dispatched only after satisfactory Third Party Inspection and certification by any one of the above TPI Agency. The items shall be supplied to NMPA site with satisfactory TPI certificate issued by TPIA along with manufacturer's certificate of supply items, performance test certificate and guarantee certificate.



5. The materials shall be dispatched to NMPA site, duly covering the transit insurance. Any damage to the items during transportation shall be to contractors account.
6. **LIQUIDATED DAMAGES:** In case of delay in supply of items, Liquidated Damages (L.D) may be levied at the rate of 0.5% of the contract price plus applicable GST per week delay, or part thereof subject to a maximum of 10% of the contract price.
7. **Payment Terms:** 90% value of total tax invoice amount will be made within 15 days after the completion of supply of items at NMPA site alongwith satisfactory TPI certificate, manufacturer's certificate of supply items, performance test certificate and guarantee certificate. Balance 10% of the total tax invoice amount will be retained as SECURITY DEPOSIT and will be released without interest after satisfactory completion of Guarantee/Warrantee period of one year from the date of receipt of materials at NMPA site. The defect, if any noticed during the guaranty period shall be rectified by the contractor at free of cost.
8. Statutory taxes as applicable will be deducted while releasing payment.
9. The offer enclosed in a sealed cover super scribed as "Supply of SS 316 Jumbo Water Curtain Nozzles with Coupling (Adapter)" should reach to the under signed on or before 26/04/2023 at 15:30 Hrs. to the below mentioned address. Quotation will be opened on the same day at 16.00 Hrs. in the presence of the bidders who wish to be present.

Encl: As above (ANNEXURE-1&2)

**Address for Communication:**

Executive Engineer (M)III,  
Administrative Building, 2nd Floor, Room No.234,  
New Mangalore Port Authority,  
Panambur, Mangalore - 575010.  
Mob: 9449700435, Ph: 0824-2887730  
Email: krishnamurthy.ds@nmpt.gov.in

  
13/04/2023  
(Krishnamurthy D S)  
Executive Engineer (M)  
कार्यपालक अभियंता (एम) III  
Executive Engineer (M) III  
नव मंगलूर पोर्टन प्राधिकरण  
New Mangalore Port Authority  
पणबूर, मंगलूर - ५७५०१०  
Panambur Mangalore - 575 010

# JUMBO WATER CURTAIN NOZZLE AND COUPLING (ADAPTER)

ANNEXURE-1

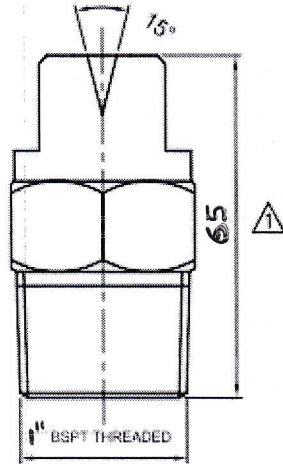

CURTAIN NOZZLE DETAILS

SR NO	DESCRIPTION	SPECIFICATION
1.	QTY.	28 NOS.
2.	K FACTOR /FLOW	362 LPM
3.	THREAD TYPE	1" BSPT(M)
4.	MATERIAL	SS:316
5.	SPRAY ANGLE COVERAGE	15 DEG
6.	VERTICAL THROW @ 7 BAR	20 MTRS
7.	WIDTH @ 7 BAR OF SPRAY	5 MTRS

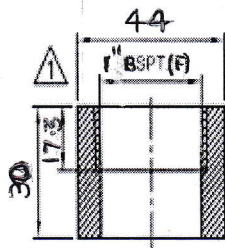
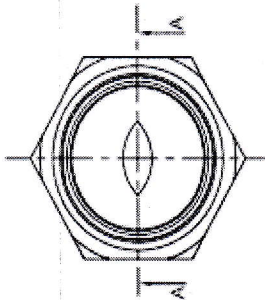

COUPLING (ADAPTER) DETAILS.

SR.NO.	DESCRIPTION	SPECIFICATION
1.	CODE	ANSI.B 16.11
2.	TYPE	HALF COUPLING
3.	THREAD CONNECTION	1" BSPT. (F)
4.	MATERIAL	SS:316
5.	QTY.	28 NOS.

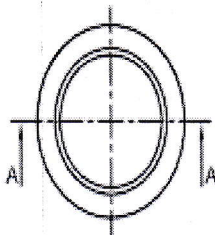

NOTE : ALL DIMENSIONS ARE IN MM  
UNLESS OTHERWISE SPECIFIED

  
 13/04/2023  
 कार्यपालक अभियंता, (एम) III  
 Executive Engineer (M) III  
 नव मंगलूर पोर्टन प्राधिकरण  
 New Mangalore Port Authority  
 पणदूर, मंगलूर - 575010  
 Paramburi Mangalore - 575 010

**ANNEXURE-2**

**PRESSURE V/S FLOW GRAPH**

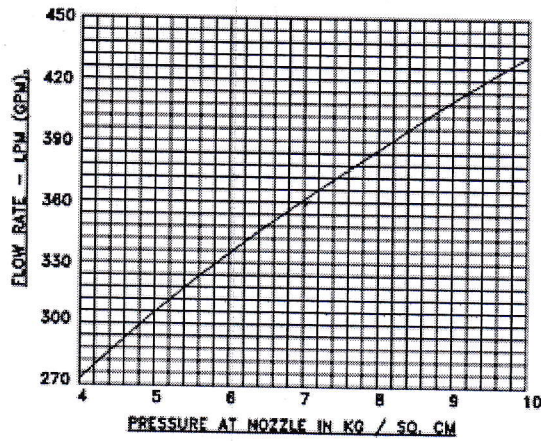

**PROJECTILE CURVE OF WATER CURTAIN NOZZLE 362 LPM @ 7 KG/CM<sup>2</sup>**

**PRESSURE V/S THROW**

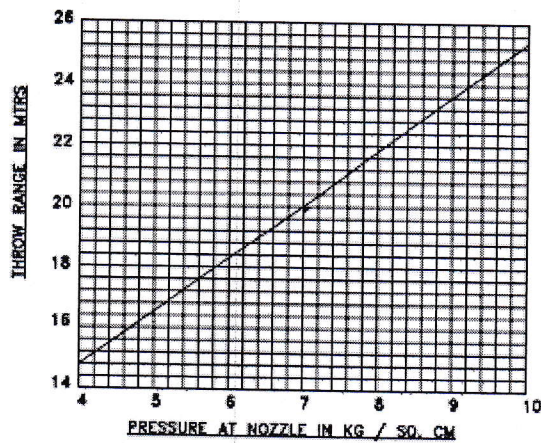

**PROJECTILE CURVE OF JUMBO WATER CURTAIN NOZZLES**

*[Signature]*  
कार्यपालक अभियंता, (एम) III 13/04/2023  
Executive Engineer (M) III  
नव मंगलूर पत्तन प्राधिकरण  
New Mangalore Port Authority  
पणवूर, मंगलूर - 575020  
Panambur Mangalore - 575 010